

# EX-P88R

## Explosion-proof IR PTZ Camera

www.vipro.com.tw



### Key features

- 304(316) stainless or electro-polished
- Auto focus, high-resolution integrated camera
- Variable Speed Pan: 0.1° to 40° /second with proportional pan
- Tilt Range from +90° to -90° from Horizontal
- Upright or Inverted Operation
- Full, two-year continuous-day warranty
- 960P or 1080P, Onvif compliant
- Support DC12V/DC24V/AC220V power range
- Application: oil field, chemical plant, port, oil storage, steamship, oil drilling platform, gas stations, coal mine, aviation, military, medicine, steel, firecrackers production, machinery, food processing and storage.

### Dimensions

(unit: mm)

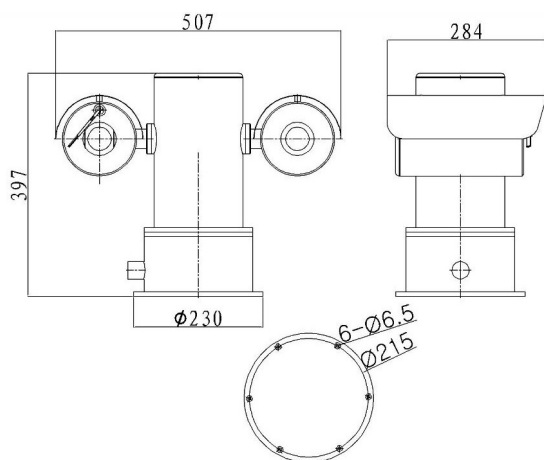

### Ordered Model:

EX-P88R-700	Analog 700TVL
EX-P88R-IP13M	IP 1.3Mega pixel
EX-P88R-IP20M	IP 2.0Mega pixel

### Accessory:

Spade PTZ Bracket	All steel, wall mount, pole mount, used for ex-proof Shield and PTZ, load 100kg
Universal Joint	Aluminum, used for proof shields and ex-proof cameras, load 30kg
Ex-proof Flexible Tube BNG	Diameter: $\phi$ 15mm Length: 1200mm Interface: rubber $\frac{1}{2}$ ", $\frac{3}{4}$ " stainless steel $\frac{3}{4}$ " Temp: -25°C ~ +70°C
Ex-proof Junction Box	Interface: $\frac{1}{2}$ ", $\frac{3}{4}$ "
Ex-proof Control Box	Stainless steel

EX-P88R is an explosion-proof PTZ Infrared camera tailor-made for the rigorous requirements for hazardous areas. Featuring 304(316) stainless steel, long-range IR distance, auto-focus, high-resolution integrated camera and upright and inverted operation, EX-P88R delivers the high image quality and reliability demanded in the most challenging environments.

Applicable for the factories with the explosive mixtures formed from class IIA, IIB and IIC T1-T6 group flammable gas, steam with air in area No.1 , No.2, and appearing the explosive hazardous area due to the mixture of flammable dust and air in area No.20, No.21 and No.22.

### Technical Specifications

Product series		Explosion-proof IR PTZ Camera
Model		EX-P88R
Mechanical features	Material quality	304 Stainless steel
	Surface treatment	Original stainless steel or Electro-polished surface (optional)
	Anti-hazard classification	Ex dIIC T6 Gb/ DIP A20 TA,T6
	Ingress Protection	IP66
	Interface spec	G-3/4"
	Weight	≤28.0kg (61.73lbs)
	Method of installation	Wall mounting
Camera	Dimension (L x W x H)	283mm x 507mm x 397mm / 11.14" x 19.96" x 15.63"
	Resolution	SONY480CP, IP1.3Mpix, IP2.0Mpix
	TV System	PAL/NTSC
	Lens	4mm/6mm
	Signal-to-Noise Ratio	> 75dB
PTZ Fuction	IR Distance	80 meters
	Max. Horizotnal Angle	0-360°
	Max. Pitching Angle	± 90°
	Horiztonal Speed	0.1-40° /sec
	Pitching Speed	0.1-40° /sec
Electrical	Zoom	18X Optical Zoom
	Input voltage	DC 12V/ DC2 4V/ AC 220V
	Working current	≤2A
Environmental	Electrical Connectivity	composite cable
	Working temperature	-30°C~+70°C / -22°F~158°F
	Atmospheric Pressure	86~106kpa
	Relative Humidity	≤ 95%RH (±25°C)
Environmental	Certification	ATEX, CNEX, CE, FCC